

# Brushes



### Description

Brush assemblies are suitable for lubricating various moving machine components such as chains, cams, open gears...  
 Oil flow to each brush must be controlled by a meter unit or a control unit.  
 The brush must be mounted close to the component to be lubricated, but the bristles should not be in contact.

### Characteristics

- Material: anodised aluminium body  
 nylon Ø 0,3  
 (bristle for standard version)  
 brass Ø 0,1  
 (bristle for "L" version)
- Working temperature: -30 to 95°C  
 (standard version)  
 up to 300°C  
 ("L" version)
- Connection: 1/8 NPT or 5/16-24NF

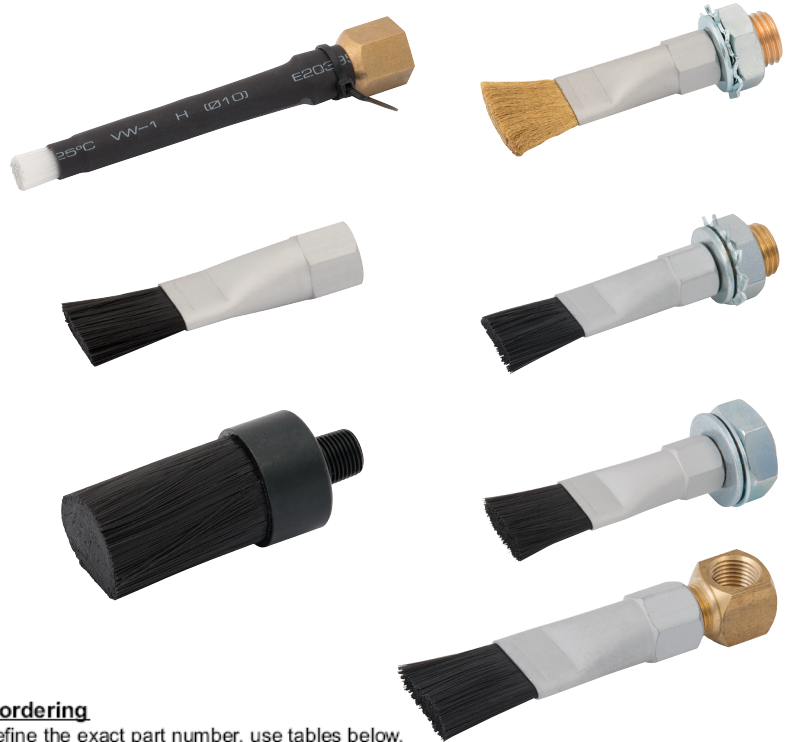

Figure 1

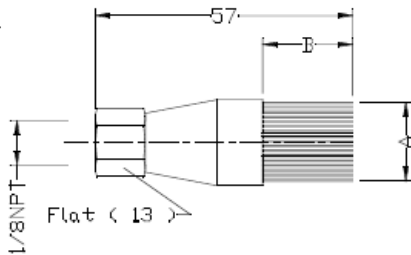

Figure 2

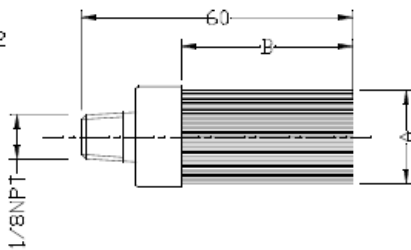
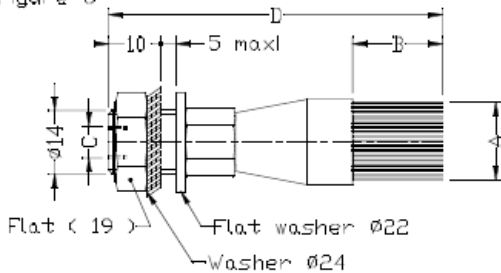

Figure 3



### For ordering

To define the exact part number, use tables below.  
 Example : Brush, width 19MM, brass bristles, 1/8NPT  
 Reference : **B7492L**

| Figure | Sizes |    |        | Bristle material | Reference |
|--------|-------|----|--------|------------------|-----------|
|        | A     | B  | C      |                  |           |
| 1      | 20x4  | 19 | 1/8NPT | nylon            | B7488     |
|        | 20x4  | 19 | 1/8NPT | brass            | B7488L    |
|        | 30x4  | 19 | 1/8NPT | nylon            | AR1473    |

| Figure | Sizes |    |        | Bristle material | Reference |
|--------|-------|----|--------|------------------|-----------|
|        | A     | B  | C      |                  |           |
| 2      | 48x14 | 35 | 1/8NPT | nylon            | 80311     |
|        | ø25   | 35 | 1/8NPT | nylon            | 80310     |

| Figure | Sizes |    |           |    | Bristle material | Reference |
|--------|-------|----|-----------|----|------------------|-----------|
|        | A     | B  | C         | D  |                  |           |
| 3      | 20x4  | 19 | 5/16-24NF | 74 | nylon            | B7491     |
|        | 20x4  | 19 | 5/16-24NF | 74 | brass            | B7491L    |
|        | 30x4  | 19 | 5/16-24NF | 74 | nylon            | AR1530    |
|        | ø25   | 35 | 5/16-24NF | 90 | nylon            | AR1583    |
|        | 48x14 | 35 | 5/16-24NF | 90 | nylon            | AR1585    |
|        | 20x4  | 19 | 1/8NPT    | 74 | nylon            | B7492     |
|        | 20x4  | 19 | 1/8NPT    | 74 | brass            | B7492L    |
|        | 30x4  | 19 | 1/8NPT    | 74 | nylon            | AR1531    |
|        | ø25   | 35 | 1/8NPT    | 90 | nylon            | AR1584    |
|        | 48x14 | 35 | 1/8NPT    | 90 | nylon            | AR1586    |
|        | 20x4  | 19 | M8x100    | 74 | nylon            | AR1964    |
|        | 20x4  | 19 | M8x100    | 74 | brass            | AR1965    |
|        | 30x4  | 19 | M8x100    | 74 | nylon            | AR1966    |
|        | ø25   | 35 | M8x100    | 90 | nylon            | AR1967    |
|        | 48x14 | 35 | M8x100    | 90 | nylon            | AR1968    |