

W3 ASFA "L" Worm-Drive Clip (Black Finish)

MIKALOR

The special black finish gives added corrosion resistance and makes this clip very popular in automotive and defence applications, as well as in the manufacture of agricultural and construction machinery.

Screw: AISI 430 stainless steel

Band and Housing: stainless steel X6Cr-17
(DIN 1.4016) (AISI-430)

Finish: black



Thanks to the exclusive design of the housing, the ASFA "L" W3 hose clip has excellent performance while being at the same time very compact.

The cold-formed stamped band thread, smoothed on the underside, combined with the beveled band edges protects the hose from any damage.

The ASFA "L" W3 hose clip complies fully with the DIN 3017 norm and also with the RoHS directive EU 2002/95/EC dated 1st July 2006.

The special black finish gives added corrosion resistance and makes this clip very popular in automotive and defense applications, as well as in the manufacture of agricultural and construction machinery.

* The maximum application pressure can vary depending on the type of hose used and the geometry of the coupling.

Patented Worldwide.

430 Stainless Steel, 9mm Bandwidth		
5556	IS-2 min mm	IS-2 max mm
73016011	8	16
73016020	12	22
73016038	16	27
73016046	20	32
73016062	25	40
73016070	30	45
73016089	32	50
73016095	40	60
73016100	50	70
73016118	60	80

ASFA "L" W3 Worm-Drive Clip (9mm bandwidth)

Application Ø		Part n° W3	L max.	s + 0,1 0	h max.	a -0,2	b Max.	Max. Values* Torque (Nm)	Max. Values* Pressure (Bars)	Box Quantity (MOQ)	Packing
mm	inches										
8-16	5/16-5/8	73016011	22,1	0,65	10,5	9	14,0	3,0	45	200	800
12-22	15/32-7/8	73016020	22,1	0,65	10,5	9	14,0	3,0	45	200	800
16-27	5/8-1-1/16	73016038	23,6	0,75	10,5	9	14,0	3,5	42	200	800
20-32	25/32-1-1/4	73016046	23,6	0,75	10,5	9	14,0	3,5	36	200	800
25-40	1-1-9/16	73016062	25,6	0,75	10,5	9	14,0	4,0	32	100	800
30-45	1-3/16-1-3/4	73016070	25,6	0,75	10,5	9	14,0	4,0	28	100	800
32-50	1-1/4-1-31/32	73016089	25,6	0,75	10,5	9	14,0	4,0	24	100	800
40-60	1-9/16-2-3/8	73016095	25,6	0,75	10,5	9	14,0	4,0	19	100	400
50-70	1-31/32-2-3/4	73016100	26,6	0,75	10,5	9	14,0	4,0	17	100	100
60-80	2-3/8-3-1/8	73016118	26,6	0,75	10,5	9	14,0	4,0	15	100	100

W3 Screw: Stainless steel (AISI-430) **Band and housing:** Stainless steel X6Cr-17 (DIN 1.4016) (AISI-430) **Finish:** Black

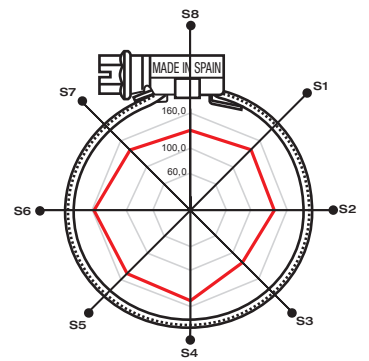
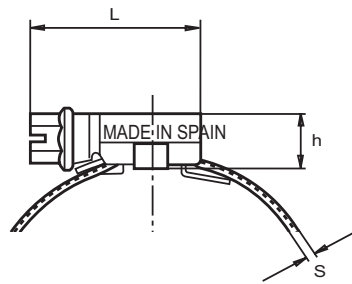
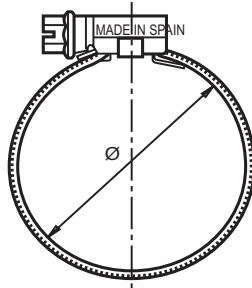
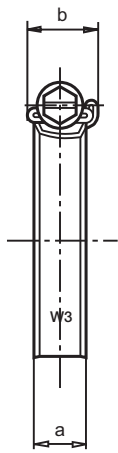

Polar Diagram

● Sectors	S1	S2	S3	S4	S5	S6	S7	S8
— 4 Nm	131,2	141,5	139,3	122,4	145,9	147,6	157,9	138,5

Torque / Efficiency [Nm / daN]