

# Malleable Iron Fittings

## Cap Rounded (300)

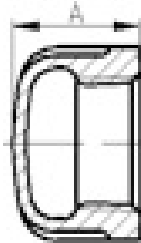

Size		Dimensions (mm)
Inch	mm	A
1/8	6	13
1/4	8	15
3/8	10	17
1/2	15	19
3/4	20	22
1	25	24
1 1/4	32	27
1 1/2	40	30
2	50	32
2 1/2	65	35
3	80	38
4	100	45
5	125	54
6	150	61