

# Quick Release Pneumatic Hose Couplings

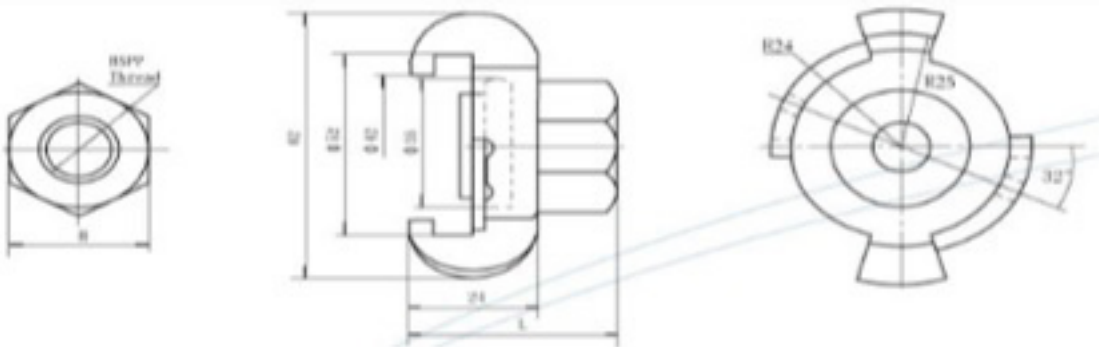

## European Execution Double Lock Claw Couplings

Steel, Female Thread, BSPP

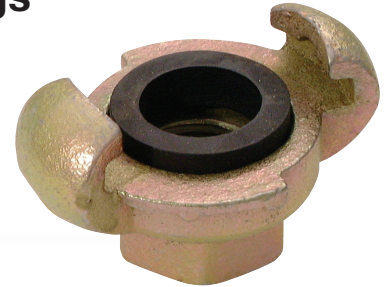

- Robust couplings of malleable iron, zinc plated and yellow passivated (free of chrome VI)
- 100% couple test and sight control
- With oil-resistant rubber ring GOER, on request with steam-resistant rubber ring GDOR (up to 200C) against charge
- Universal coupling, world-wide used system for compressed air in construction and industry

PART NO	SIZE	L	H	BSPP
CCF-38	3/8"	37	22	3/8"
CCF-12	1/2"	37	28	1/2"
CCF-34	3/4"	40	32	3/4"

PART NO	HOSE I.D	MAX. WORKING PRESSURE	TEMP.	MATERIAL	SEAL	THREADS	MEDIUM	CLAW DISTANCE
CCF-38	3/8"	PN 10 BAR	-40°C-+95°C	Steel	NBR	ISO 228	Compressed Air	42 mm
CCF-12	1/2"	PN 10 BAR	-40°C-+95°C	Steel	NBR	ISO 228	Compressed Air	42 mm
CCF-34	3/4"	PN 10 BAR	-40°C-+95°C	Steel	NBR	ISO 228	Compressed Air	42 mm