

Serie 89000

 89000 Pag. 6.6	 89010 Pag. 6.6	 89030 Pag. 6.6	 89040 Pag. 6.7	 89050 Pag. 6.7	 89106 Pag. 6.7	 89111 Pag. 6.7	 89116 Pag. 6.8	 89130 Pag. 6.8
 89211 Pag. 6.8	 89216 Pag. 6.8	 89223 Pag. 6.9	 89226 Pag. 6.9	 89230 Pag. 6.9	 89310 Pag. 6.9	 89500 Pag. 6.10	 88610 Pag. 6.10	 89700 Pag. 6.10
 50980 Pag. 6.10	 50990 Pag. 6.10	 50006 Pag. 6.10						



Serie 89000

RACCORDI AD INNESTO AUTOMATICO CON SPINTORE IN METALLO PER TUBI IN POLLICI - INCH TUBE PUSH-IN FITTINGS WITH METAL COLLET

89000

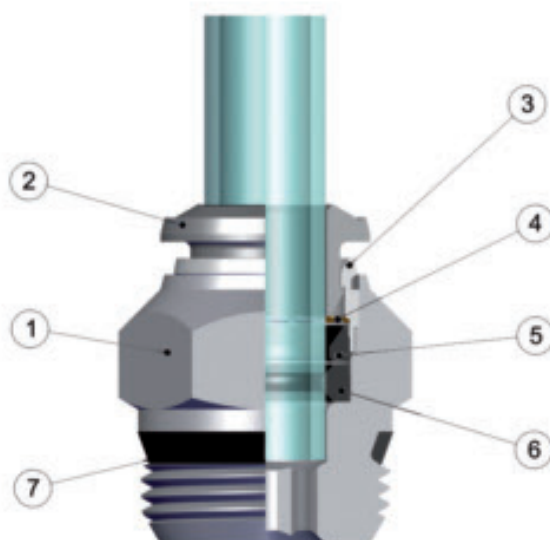
Caratteristiche Tecniche / Technical Characteristics

**FKM O EPDM
A RICHIESTA
IF REQUESTED
FKM OR EPDM**

Materiali e Componenti / Component Parts and Materials

- | | |
|---|----------------------------------|
| 1 Corpo in Ottone Nichelato | 1 Nickel-plated brass Body |
| 2 Spintore sgancio tubo in Ottone Nichelato | 2 Nickel-plated brass Collet |
| 3 Capsula in ottone nichelato | 3 Nickel-plated brass Capsule |
| 4 Pinza d'aggraffaggio in acciaio inox aisi 301 | 4 Steel aisi 301 Clamping washer |
| 5 Anello di sicurezza in Tecnopolimero | 5 Technopolymeric Safety ring |
| 6 Guarnizione a labbro in NBR | 6 Nbr Lip seal |
| 7 Guarnizione filetto in NBR | 7 Nbr Thread packing |

Pressioni / Pressures

Pressione minima / Minimum pressure: **-0.99 bar (-0.099 MPa)**
 Pressione massima / Maximum pressure: **15 bar (1.5 MPa)**

Filettature / Threads

Filettatura conica "short"
 "Short" taper thread.
Gas conica conforme ISO 7.1, BS 21, DIN 2999
 Tapered gas in conformity with ISO 7.1, BS 21, DIN 2999.
Gas cilindrica conforme ISO 228 Classe A
 Parallel gas in conformity with ISO 228 Class A.

Tubi di collegamento / Connection Tubes

Tubi in materiale plastico:
 PA6, PA11, PA12, Polietilene, *Poliuretano, PTFE, FEP.
 *Per tubi in Poliuretano é consigliata una durezza di 98 shore.
 Plastic tubes:
 PA6, PA11, PA12, Polyethylene, *Polyurethane, PTFE, FEP.
 *For Polyurethane hoses it is required a minimum hardness of 98 shore.

Temperature / Temperatures

Temperatura minima / Minimum temperature: **-20 °C**
 Temperatura massima / Maximum temperature: **+80 °C**

Con Guarnizioni FKM / With FKM Seals
 Temperatura minima / Minimum temperature: **-15 °C**
Temperatura massima in continuo: **+130 °C**
 Maximum temperature in continuos:
Temperatura massima per breve durata: **+185 °C**
 Maximum temperature for short term:

Con Guarnizioni EPDM / With EPDM Seals
 Temperatura minima / Minimum temperature: **-40 °C**
Temperatura massima in continuo: **+130 °C**
 Maximum temperature in continuos:
Temperatura massima per breve durata: **+160 °C**
 Maximum temperature for short term:

Fluidi compatibili / Fluids

Aria compressa / Compressed air.
 Vuoto / Vacuum
 Acqua / Water
 Vapore / Steam

Filettature / Threads

La filettatura conica "short" è progettata per soddisfare le seguenti caratteristiche:

- ridurre la lunghezza d'ingombro
- ridurre la chiave rispetto ad alcuni raccordi con filettature cilindriche
- consentire l'accoppiamento con diversi standard di filettature femmina sia coniche che cilindriche

The "short" taper thread has been designed to offer the following advantages to the users:

- reduced overall length;
- smaller hex dimensions compared to the parallel threads;
- to allow the assembly with different female threads both taper as well as parallel;

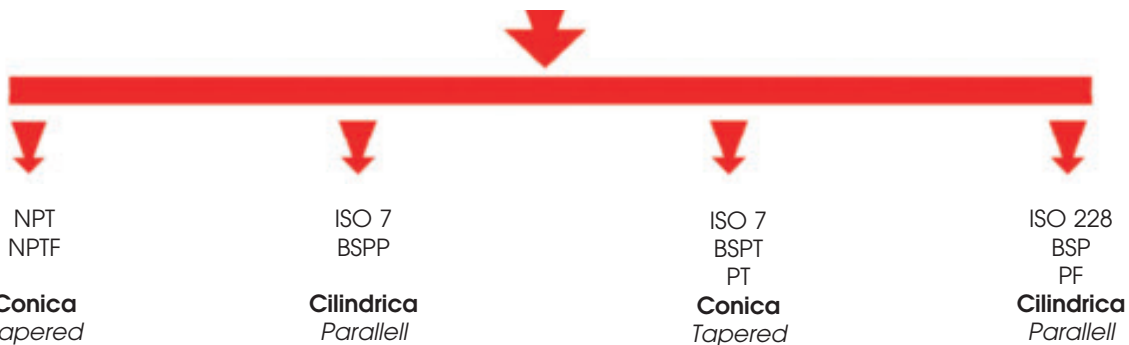

Consentire una completa tenuta anche su superfici non perfettamente piane, concave, convesse o inclinate, con diversi smussi o raggi.

To ensure the right tightening also with surfaces not perfectly flat, without spot-facing, concave convex and with different kinds of chamfers or radius.



Inclinate
Inclined



Concave
Concave



Convesse
Convex

Coppia di serraggio / Torque specifications



COPPIE DI SERRAGGIO PER FILETTATURE MASCHIO UNF
TORQUE TO MALE THREADS UNF

MISURA MEASURE	COPPIA CONSIGLIATA Nm RECOMMENDED TORQUE Nm	COPPIA DI ROTTURAZIONE Nm BREAKING TORQUE Nm
10/32	0,8	3,2

I VALORI DI ROTTURAZIONE POSSONO VARIARE IN BASE ALL'ARTICOLO
BREAKING VALUES MAY VARY ACCORDING TO THE ITEM



COPPIE DI SERRAGGIO PER FILETTATURE MASCHIO "SHORT"
TORQUE TO MALE THREADS "SHORT"

MISURA MEASURE	COPPIA MINIMA CONSIGLIATA Nm RECOMMENDED MINIMUM TORQUE Nm	COPPIA MASSIMA CONSIGLIATA Nm RECOMMENDED MAX TORQUE Nm
1/8	5	7
1/4	5	7
3/8	5	7
1/2	5	7

I VALORI DI ROTTURAZIONE POSSONO VARIARE IN BASE ALL'ARTICOLO
BREAKING VALUES MAY VARY ACCORDING TO THE ITEM

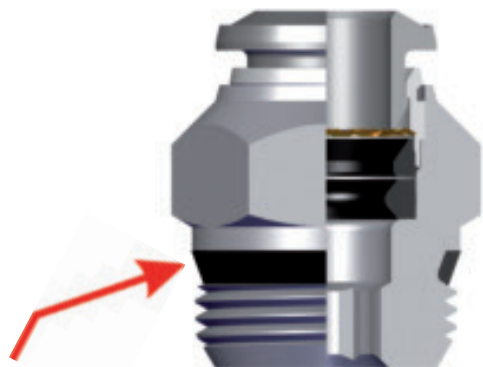
Filettature / Threads

Anello di tenuta per filetti "short".

Thread packing for the "short" taper threads.

Tutte le filettature di questa serie (anche la misura da M5) sono state dotate di elementi di tenuta che permettono l'immediato utilizzo dei raccordi riducendo notevolmente i tempi di installazione.

All of threads from this range (also the M5), have been equipped with tightening parts which allow the direct assembly of the fittings, reducing the installation time.

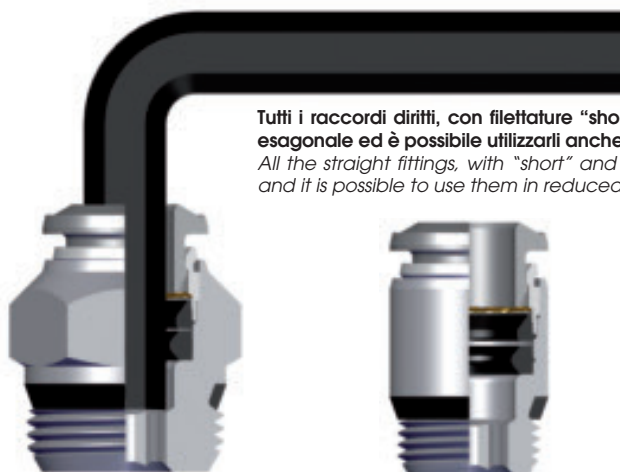

Tutti i raccordi dritti, con filettature "short" o cilindriche, possono essere montati anche con chiave esagonale ed è possibile utilizzarli anche in spazi molto ridotti.

All the straight fittings, with "short" and parallel threads can be assembled also with Allen wrench and it is possible to use them in reduced spaces.

Aggraffaggio Pinza / Clamping washer

La pinza in acciaio inox garantisce il perfetto aggraffaggio di tubi di qualsiasi materiale senza danneggiarne la superficie.

The washer is made in stainless steel ensures the perfect tube clamping with every kinds of materials without damage the surface.

Il collegamento tra tubo e raccordo assicura una tenuta totale anche in condizioni di urti e vibrazioni.

The connection between the tube and the fitting ensure a total tightness even in severe conditions such as impact and vibrations.

La particolare geometria della guarnizione permette inoltre l'utilizzo dei raccordi anche con il vuoto.

The particular geometric shape of the seal ensure the perfect tightness even with vacuum.

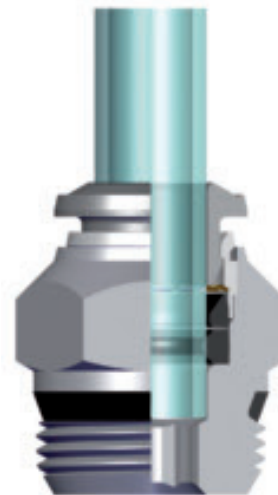

89000

RACCORDO DIRITTO MASCHIO SHORT - STRAIGHT MALE ADAPTOR (SHORT)

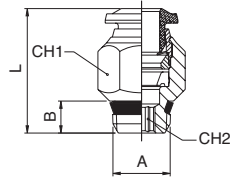

Codice Code	Tubo Tube	A	B	L	CH1	CH2	Conf. Pack.
8900000001	1/8	1/8	5.5	16.5	11	2	10
8900000002	1/8	1/4	7	18.5	11	2	10
*8900000003	5/32 (4)	1/8	5.5	18	11	3	10
*8900000004	5/32 (4)	1/4	7	19	14	3	10
8900000005	1/4	1/8	6.5	21.5	13	4	10
8900000006	1/4	1/4	7	20.5	14	4	10
8900000007	1/4	3/8	7.5	23	17	4	10
*8900000008	5/16 (8)	1/8	5.5	24.5	14	5	10
*8900000009	5/16 (8)	1/4	7	22	14	6	10
*8900000010	5/16 (8)	3/8	7.5	23	17	6	10
8900000011	3/8	1/8	5.5	27.5	17	6	10
8900000012	3/8	1/4	7	27.5	17	5	10
8900000013	3/8	3/8	7.5	25.5	17	7	10
8900000014	3/8	1/2	9	25.5	21	7	10
8900000015	1/2	1/8	5.5	32	20	5	10
8900000016	1/2	1/4	7	31	20	7	10
8900000017	1/2	3/8	7.5	31	20	9	10
8900000018	1/2	1/2	9	31	21	10	10
8900000019	1/8	10/32	5	19	8	2	10
8900000020	5/32 (4)	10/32	5	21	10	2	10
8900000021	1/4	10/32	5	24.5	13	2	10
*8900000022	5/16 (8)	1/2	9	23.5	21	6	10

*Articoli in comune con serie 57000 per tubi metrici
 *Items in common with series 57000 for metric tubes

89010

RACCORDO DIRITTO MASCHIO SHORT ESAGONO INCASSATO - STRAIGHT MALE ADAPTOR (SHORT) WITH EXAGON EMBEDDED

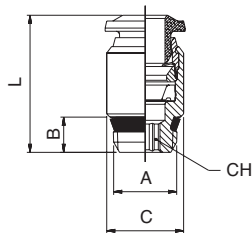

Codice Code	Tubo Tube	A	B	C	L	CH	Conf. Pack.
*8901000001	5/32 (4)	1/8	7.5	10	19	3	10
*8901000002	5/16 (8)	1/8	7.5	14	25.5	5	10
*8901000003	5/16 (8)	1/4	11	14	25	6	10

*Articoli in comune con serie 57000 per tubi metrici
 *Items in common with series 57000 for metric tubes

89030

RACCORDO DIRITTO FEMMINA (NPTF) - STRAIGHT FEMALE ADAPTOR (NPTF)

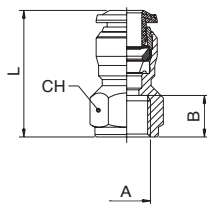

Codice Code	Tubo Tube	A - NPTF	B	L	CH	Conf. Pack.
8903000001	1/8	1/8	9.5	24	13	10
8903000002	1/8	1/4	13.5	29	16	10
8903000003	5/32	1/8	9.5	24.5	13	10
8903000004	5/32	1/4	13.5	29.5	16	10
8903000005	1/4	1/8	9.5	26	13	10
8903000006	1/4	1/4	13.5	31	16	10
8903000007	3/8	1/4	13.5	34.5	18	10
8903000008	3/8	3/8	13.5	34.5	20	10

89040

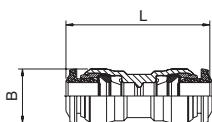
RACCORDO DIRITTO INTERMEDIO - STRAIGHT CONNECTOR

Codice Code	Tubo Tube	Tubo Tube	L	B	Conf. Pack.
890400001	1/8		8,5	26	10
*570400001	5/32 (4)		10,5	30,5	10
890400003	1/4	5/32	12,5	33	10
890400004	1/4		12,5	34	10
*570400008	3/16 (5)		33	11,5	10
*570400005	5/16 (8)		14,5	36	10
890400006	3/8	1/4	17,5	41	10
890400009	3/8	1/2	20,5	41	10
890400007	3/8		17,5	41	10
890400008	1/2		20,5	47	10

*Articoli in comune con serie 57000 per tubi metrici
 * Items in common with series 57000 for metric tubes

89050

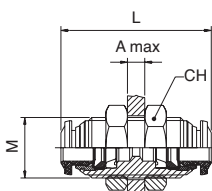
RACCORDO DIRITTO INTERMEDIO DI ATTRAVERSAMENTO - BULKHEAD CONNECTOR

Codice Code	Tubo Tube	M	L	CH	A max	Conf. Pack.
890500001	1/8	M10x1	26	14	5	10
*570500001	5/32 (4)	M12x1	31,5	17	7	10
890500003	1/4	M14x1	35	17	9,5	10
*570500003	5/16 (8)	M16x1	37	19	10,5	10
890500005	3/8	M20x1	42	24	12,5	10
890500006	1/2	M22x1	48	26	16,5	10

*Articoli in comune con serie 57000 per tubi metrici
 * Items in common with series 57000 for metric tubes

89106

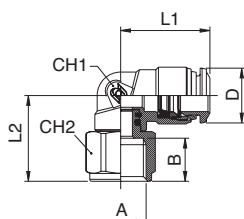
RACCORDO A L FEMMINA ORIENTABILE (NPTF) - ORIENTING ELBOW FEMALE ADAPTOR (NPTF)

Codice Code	Tubo Tube	A - NPTF	B	L1	L2	CH1	CH2	D	Conf. Pack.
891060001	5/32	1/8	9,5	17,5	17,5	9	13	10	10
891060002	5/32	1/4	13,5	17,5	20	9	16	10	10
891060003	1/4	1/8	9,5	21,5	19	11	13	12,5	10
891060004	1/4	1/4	13,5	21,5	21,5	11	16	12,5	10
891060005	3/8	1/8	9,5	27	23	13	13	17,5	10
891060006	3/8	1/4	13,5	27	24	16	16	17,5	10

89111

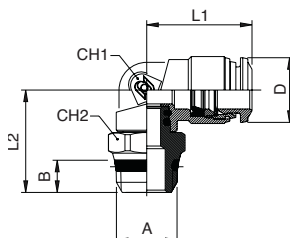
RACCORDO A L ORIENTABILE MASCHIO SHORT - ORIENTING ELBOW MALE ADAPTOR (SHORT)

Codice Code	Tubo Tube	A	B	L1	L2	CH	CH2	D	Conf. Pack.
891110001	1/8	1/8	7	18	18	9	13	10	10
891110002	1/8	1/4	8,5	18	19,6	9	15	10	10
*891110003	5/32 (4)	1/8	5,5	18	19,5	9	13	10	10
*891110004	5/32 (4)	1/4	7	18	21	9	15	10	10
891110005	1/4	1/8	7	22,5	19,7	11	13	12,5	10
891110006	1/4	1/4	8,5	22,5	19,7	11	15	12,5	10
891110007	1/4	3/8	9	22,5	19,7	11	17	12,5	10
*891110008	5/16 (8)	1/8	5,5	22,5	22,5	12	13	14,5	10
*891110009	5/16 (8)	1/4	7	22,5	22,5	12	15	14,5	10
*891110010	5/16 (8)	3/8	7,5	22,5	23	12	17	14,5	10
*891110018	5/16 (8)	1/2	9	22,5	25,5	12	21	14,5	10
8911100011	3/8	1/8	7	26,5	26	14	14	17,5	10
8911100012	3/8	1/4	8,5	26,7	26	14	17,5	17,5	10
8911100013	3/8	3/8	9	24,7	26	14	17,5	17,5	10
8911100014	3/8	1/2	8,5	26,7	26	17	15	17,5	10
8911100015	1/2	1/4	8,5	30,5	28,7	16	15	17,5	10
8911100016	1/2	3/8	7,5	31,5	26,5	16	20	21,5	10
8911100017	1/2	1/2	9	31,5	29	16	21	21,5	10

*Articoli in comune con serie 57000 per tubi metrici
 * Items in common with series 57000 for metric tubes

89116

RACCORDO A L ORIENTABILE MASCHIO CILINDRICO - ORIENTING ELBOW MALE ADAPTOR (PARALLEL)

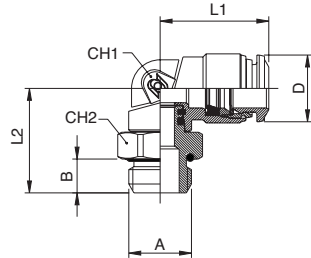

Codice Code	Tubo Tube	A	B	L1	L2	CH1	CH2	D	Conf. Pack.
891160001	1/8	10/32	5	18	20	9	8	10	10
891160002	5/32	10/32	5	18	20	9	8	10	10
891160003	1/4	10/32	5	21	22	11	8	12.5	10

*Articoli in comune con serie 57000 per tubi metrici
* Items in common with series 57000 for metric tubes

89130

RACCORDO A L INTERMEDIO - ELBOW CONNECTOR

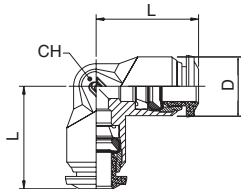

Codice Code	Tubo Tube	L	CH	D	Conf. Pack.
*571300001	5/32 (4)	17	9	10	10
891300001	1/8	16.5	9	10	10
891300003	1/4	21	11	12.5	10
*571300003	5/16 (8)	22.5	13	14	10
891300005	3/8	26	16	17.5	10
891300006	1/2	30.5	19	21.5	10

*Articoli in comune con serie 57000 per tubi metrici
* Items in common with series 57000 for metric tubes

89211

RACCORDO A T ORIENTABILE MASCHIO SHORT - ORIENTING TEE MALE ADAPTOR (SHORT) - CENTRE LEG

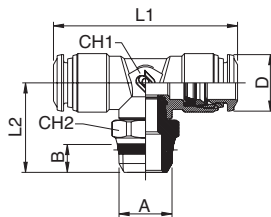

Codice Code	Tubo Tube	A	B	L1	L2	CH1	CH2	D	Conf. Pack.
*8921100016	5/16 (8) 1/8	5.5	45	25.5	13	13	14.5	10	
*8921100015	5/16 (8) 1/4	7	45	25.5	13	15	14.5	10	
*8921100017	5/16 (8) 3/8	7.5	45	26	13	17	14.5	10	
8921100001	1/8 1/8	5.5	34	17	9	8	10	10	
8921100002	1/8 1/4	7	34	20	9	15	10	10	
*8921100003	5/32 (4) 1/8	5.5	34	20	9	13	10	10	
*8921100004	5/32 (4) 1/4	7	34	21.5	9	15	10	10	
8921100005	1/4 1/8	5.5	40	20	11	13	12.5	10	
8921100006	1/4 1/4	7	40	21.5	11	16	12.5	10	
8921100007	1/4 3/8	7.5	40	22	11	17	12.5	10	
8921100014	3/8 1/8	5.5	52	26.5	14	14	17.5	10	
8921100008	3/8 1/4	7	52	29	14	16	17.5	10	
8921100009	3/8 3/8	7.5	52	27	14	17	17.5	10	
8921100010	3/8 1/2	9	52	31	14	21	17.5	10	
8921100011	1/2 1/4	7	61	31.5	16	15	21.5	10	
8921100012	1/2 3/8	7.5	61	29.5	16	17	21.5	10	
8921100013	1/2 1/2	9	61	32	16	21	21.5	10	

*Articoli in comune con serie 57000 per tubi metrici
* Items in common with series 57000 for metric tubes

89216

RACCORDO A T ORIENTABILE MASCHIO CILINDRICO - ORIENTING TEE MALE ADAPTOR (PARALLEL) CENTRE LEG

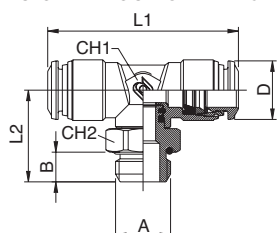

Codice Code	Tubo Tube	A	B	L1	L2	CH1	CH2	D	Conf. Pack.
8921600001	1/8 10/32	3.5	33	17	9	8	10	10	
8921600002	5/32 10/32	3.5	34	18	9	8	10	10	
8921600003	1/4 10/32	3.5	42	20.5	11	11	12.5	10	

89223

RACCORDO A T ORIENTABILE MASCHIO LATERALE SHORT - ORIENTING TEE MALE ADAPTOR (SHORT) OFF - SET LEG

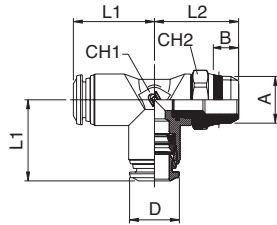

Codice Code	Tubo Tube	A	B	L1	L2	CH1	CH2	D	Conf. Pack.
*8922300015	5/16 (8)	1/8	5.5	22.5	24	13	13	14.5	10
*8922300016	5/16 (8)	1/4	7	22.5	24	13	15	14.5	10
*8922300017	5/16 (8)	3/8	7.5	22.5	27	13	17	14.5	10
8922300001	1/8	1/8	5.5	16.5	18.5	9	13	10	10
8922300002	1/8	1/4	7	16.5	20.5	9	15	10	10
*8922300003	5/32 (4)	1/8	5.5	17	20	9	13	10	10
*8922300004	5/32 (4)	1/4	7	17	21.5	9	15	10	10
8922300005	1/4	1/8	5.5	21.5	20	11	13	12.5	10
8922300006	1/4	1/4	7	21.5	21.5	11	15	12.5	10
8922300007	1/4	3/8	7.5	21.5	22	11	17	12.5	10
8922300014	3/8	1/8	7	27	26	14	14	17.5	10
8922300008	3/8	1/4	7	27	26.5	14	16	17.5	10
8922300009	3/8	3/8	7.5	27	27	14	17	17.5	10
8922300010	3/8	1/2	9	27	29	14	21	17.5	10
8922300011	1/2	1/4	7	31.5	31.5	16	15	21.5	10
8922300012	1/2	3/8	7.5	31.5	31.5	16	15	21.5	10
8922300013	1/2	1/2	9	31.5	32.5	16	21	21.5	10

*Articoli in comune con serie 57000 per tubi metrici
* Items in common with series 57000 for metric tubes

89226

RACCORDO A T ORIENTABILE MASCHIO LATERALE CILINDRICO - ORIENTING TEE MALE ADAPTOR (PARALLEL) OFF - SET LEG

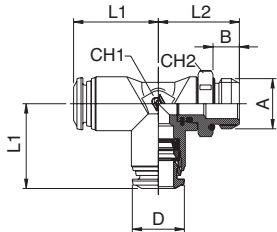

Codice Code	Tubo Tube	A	B	L1	L2	CH1	CH2	D	Conf. Pack.
8922600001	1/8	10/32	3.5	16.5	17	9	8	10	10
8922600002	5/32	10/32	3.5	17	18	9	8	10	10
8922600003	1/4	10/32	3.5	21	20.5	11	11	12.5	10

89230

RACCORDO A T INTERMEDIO - TEE CONNECTOR

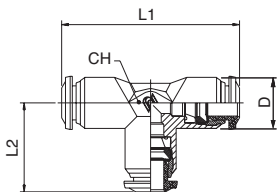

Codice Code	Tubo Tube	L1	L2	CH	D	Conf. Pack.
8923000001	1/8	33	17	9	10	10
*5723000001	5/32 (4)	34	17	9	14	10
8923000003	1/4	42	21	11	12.5	10
*5723000003	5/16 (8)	45	22.5	13	10	10
8923000005	3/8	53	26.5	16	17.5	10
8923000006	1/2	61	30.5	19	21.5	10

*Articoli in comune con serie 57000 per tubi metrici
* Items in common with series 57000 for metric tubes

89310

RACCORDO A Y INTERMEDIO - Y CONNECTOR

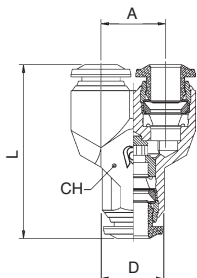

Codice Code	Tubo Tube	A	L	CH	D	Conf. Pack.
8931000001	1/8	10	29	11	10	10
*5731000001	5/32 (4)	11	32	11	10	10
8931000003	1/4	13.5	36.5	13	12.5	10
*5731000003	5/16 (8)	15.5	41	13	14	10
8931000005	3/8	18.5	48	18	17.5	10

*Articoli in comune con serie 57000 per tubi metrici
* Items in common with series 57000 for metric tubes

89500

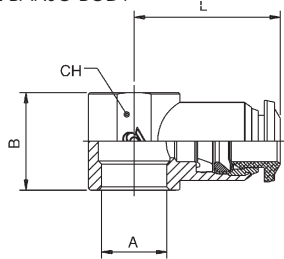
ANELLO ORIENTABILE A L - SINGLE BANJO BODY

Codice Code	Tubo Tube	A	B	L	CH	Conf. Pack.
575000003	5/32 (4)	1/8	15	21	14	10
575000001	5/32 (4)	10/32	12.5	19	-	10
895000002	1/8	1/8	15	19	14	10
895000004	1/4	1/8	15	22.5	14	10
895000005	1/4	1/4	17	25	18	10
895000006	3/8	1/4	17	29	18	10
895000007	3/8	3/8	20	30.5	21	10
895000008	1/2	3/8	20	32	21	10
895000009	1/2	1/2	24	35	25	10

*Articoli in comune con serie 57000 per tubi metrici
 *Items in common with series 57000 for metric tubes

88610

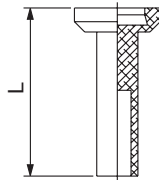
TAPPO IN POLIAMIDE - POLYAMIDE PLUG

Codice Code	Tubo Tube	L	Conf. Pack.
88610003102NE	1/8	18	25
88610003127NE	5/32-(4)	23.5	25
88610003103NE	1/4	24.5	25
88610003128NE	5/16-(8)	26	25
88610003104NE	3/8	28.5	25
88610003105NE	1/2	28.5	25

89700

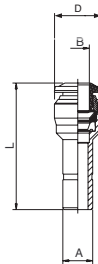
RIDUZIONE - REDUCER

Codice Code	A	B	L	D	Conf. Pack.
897000001	1/4	1/8	30	8.5	10
897000002	1/4	5/32	30	10.5	10
577000008	5/16 (8)	5/32 (4)	33	14	10
897000003	3/8	1/4	35.5	17	10
897000004	1/2	1/4	43	12.5	10
897000005	1/2	3/8	43	17.5	10
897000006	3/8	5/16	36.5	17	10

*Articoli in comune con serie 57000 per tubi metrici
 *Items in common with series 57000 for metric tubes

50980

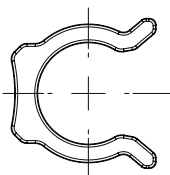
CLIP DI SICUREZZA - SECURITY CLIPS

Codice Code	Tubo Tube	Conf. Pack.
509800032X1RO	4-(5/32)	50
509800032X3RO	5	50
509800032X4RO	6-(1/4)	50
509800032X7RO	8-(5/16)	50
509800032X9RO	10-(3/8)	50
509800032Y1RO	12-(1/2)	50
509800032Y3RO	14	50

50990

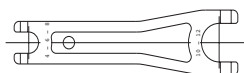
LEVA SGANCIO ADATTATORI - TOOL FOR DISASSEMBLING

Codice Code	Conf. Pack.
509900001	10

50006

ANELLO DI TENUTA PER FILETTI CONICI - THREAD PACKING FOR TAPER THREADS

Codice Code	Filetto Thread	Conf. Pack.
5000600240200	1/8	10
5000600240300	1/4	10
5000600240400	3/8	10
5000600240500	1/2	10